



SMACK DOWN™

by S.A.F.E. Archery®

**SETS UP
IN LESS
THAN A
MINUTE!**

SMACK DOWN™ SET-UP GUIDE



- Contents:
- 1 - Target Base w/Black Light
 - 4 - Target Faces
 - 1 - S.A.F.E. Archery® Longbow
 - 8 - S.A.F.E. Archery® Arrows
 - 1 - Power cord
 - 1 - Storage Bag or Transport Case

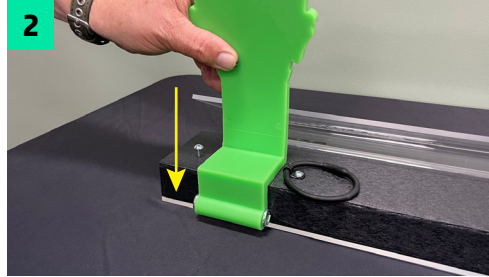

Place each target on the back of the base between the two eyelets, facing forward.

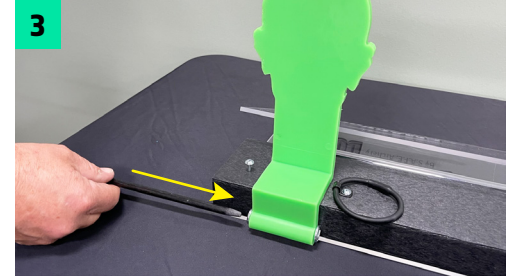

After all 4 targets are in place, slide pointed end of the rod through the eyelets and the bottom tube of target.

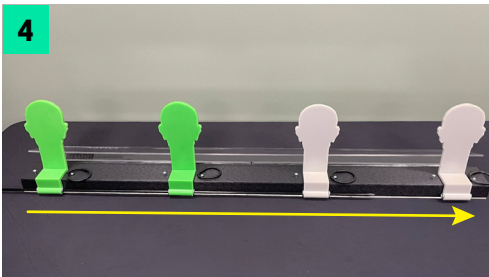

Continue pushing rod through all four targets.

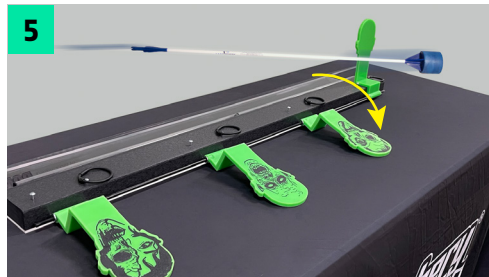

You are set if you want the targets to "Smack Down™" when hit by the arrows.

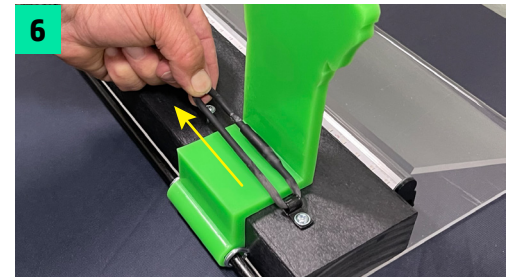

If you want the targets to wobble when hit, stretch the bungee across the targets and hook on the base screw.

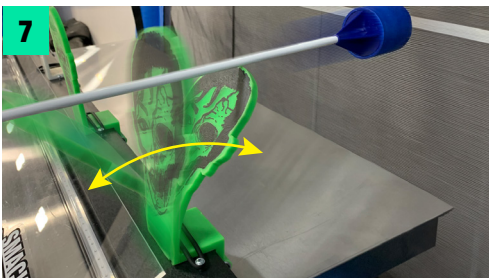

Now the targets will wobble back & forth and won't need to be set back up between hits.



Repeat attaching bungees on each target as desired.

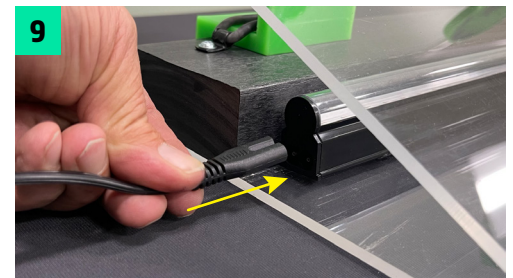

If playing indoors or in the dark, plug the power cord into the black light strip on the Smack Down™ base.



Then plug the power cord into an outlet and turn the power cord switch on.

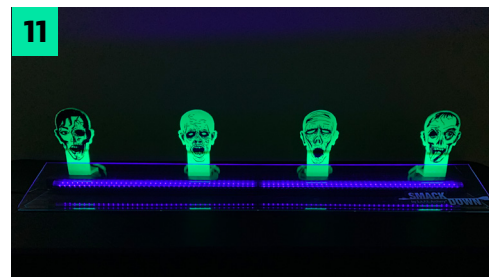

Place Smack Down™ target on a table or any flat surface, and turn off the lights for some spooky fun.

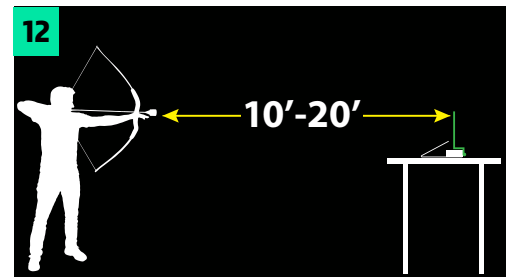

String your bow and you are ready to go! 10-20 feet shooting distance recommended depending on age & skill level.

SMACK DOWN™ TAKE-DOWN GUIDE TAKE DOWN IN LESS THAN A MINUTE!

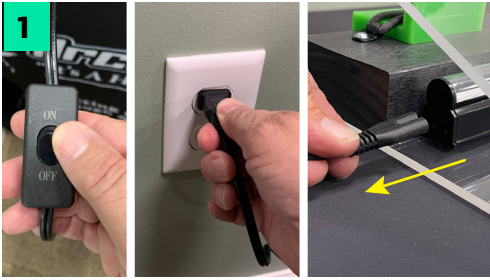

1 If using the black light, turn off switch. Unplug from outlet. Unplug power cord from target base.



2 Remove bungees from screw on any targets strapped down.

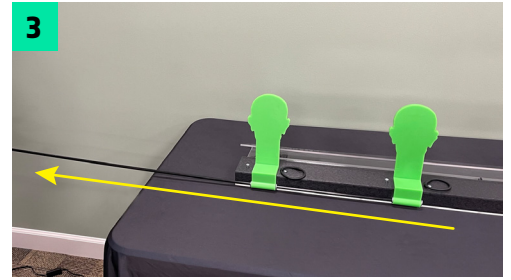

3 Pull rod from four targets and eyelets on base and remove four targets from base.

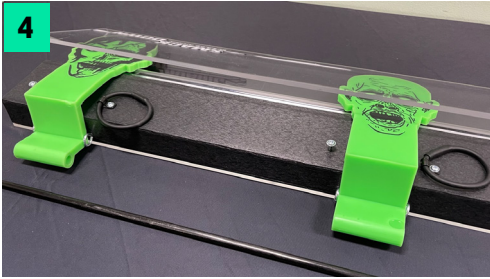

4 Turn targets over (face up) and place back on base inside plexi wedge between targets (as shown).

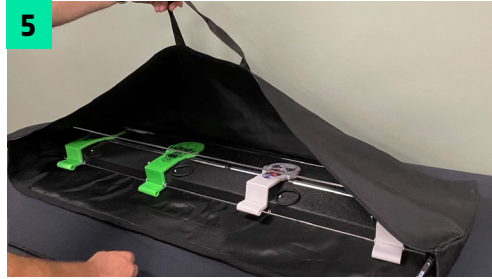

5 When using the Storage Bag, place the target base with the plexi wedge side in first (with targets laying on the base).



6 Place rod in bottom of bag. Unstring bow and place in bag still assembled.



7 Place arrows (4 facing right, 4 facing left) and power cord in bag. Zip and go!



8 When using the Transport Case, open the case and make sure targets are face up on base inside plexi wedge.



9 Turn target base so the bottom of the targets are at the back of the case. Place the rod in the back bottom of case.



10 Next place the arrows in the case (4 facing right, 4 facing left).



11 Unstring Bow, remove one limb and place in case. Now put the power cord in case and you are done.



12 Close and latch the Transport Case and you are ready for your next event.



S.A.F.E. Archery® is a registered trademark of Global Archery Products, Inc. Registered in the U.S. and other countries. © 2023 Global Archery Products, Inc., All Rights Reserved.

SafeArchery.com

Global Archery
101 Archery Way, Ashley, IN 46705
260.587.4500
info@globalarchery.com



v. 1.0